

NOTICE

Do not at any time attach wear insert or remove wear insert from seed firmer while attached to planter. Remove seed firmer while doing maintenance. Beware of all pinch points. Do not backup planter while firmer is down. Always be moving forward when lowering planter.

3600 Kinze Planter - Instructions



Parts included

Above are the parts included in the 3600 Kinze assembly.

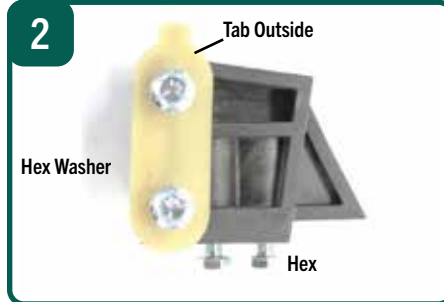

Top Assembly

Keep spacer tabs pointed outside. Use the hex washer bolt on the spacer tab.

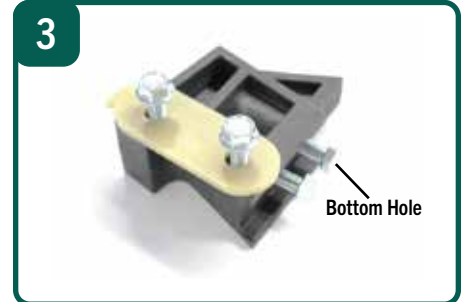

Firmer connection

Use the bottom hole location when attaching the assembly to the firmer S bracket.

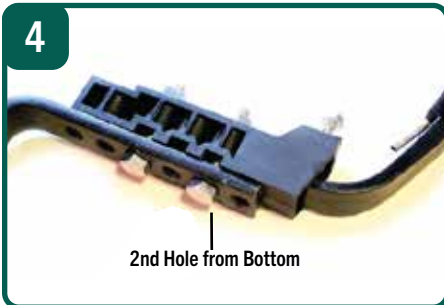

Parts included

Start with the 2nd hole from the bottom to attach firmer. Adjust to your conditions.

420 W - Instructions



Parts included

Above are the parts included in the 420 W assembly.



Full view

View of full assembly attach firmer block to firmer as shown.



Mounting block view

Screw firmer block screw in until it hits firmer. Then, back out the screw 2 full turns.

Warranty: Flo-Rite™ Seed Firmers are warranted to be free of defects in material and workmanship for one year from date of installation, any other warranty, such as merchantability or fitness for a particular purpose, is expressly disclaimed. Our obligation under this warranty shall be limited to repairing or replacing, free of charge to the original purchaser, any part that in our judgment shall show evidence of such defect, provided further that such part shall be returned within thirty (30) days from the date of failure – routed through the dealer from whom the purchase was made. Shipping charges prepaid. Patent pending Flo-Rite™ Seed Firmers shall have no liability of any kind, except for the warranty above, on account of any of its products and shall not be liable for special or consequential damages. Flo-Rite™ Seed Firmers shall not be liable for indirect, incidental or consequential damages or injuries including but not limited to loss of crops, loss of profits, rental of substitute equipment, planting delays, any expense or loss incurred for labor, other commercial loss or for any other reason. Patent pending.

WARNING: Never backup planter with seed firmers down. This may break and/or damage firmer or wear inserts.